

GAS POWERED NAILER OWNER'S MANUAL



To reduce the risk of possible injury. User must read this manual before operate, handle, maintain this tool.
Please keep this manual in safe place for future reference.

Table of content

1.	General warning	3
	General safety warning	3
	Tool safety warning	3-4
	Fuel safety warning	5
	Battery safety warning	5
	Charger safety warning	5-6
2.	Operation instruction	6
	Load and unload the fuel cell	6
	Load and unload the fastener	6-7
	Depth of drive adjustment	7
	Actuate method and the steps to fire the tool	7
	Jam clearing for tool	8
	Charge the battery and LED on tool and charger	9
3.	Maintenance instruction	9
	General maintenance	9
	Lubrication and cleaning	9
	Cold weather	9
4.	Trouble shooting	10-11
5.	Declaration of conformity	12

1. General warning

General safety warning

- User must wear eye protection which conforms to ANSI specification with front and side protection against flying object; when handling, operating, and servicing the tool. It is employer's responsibility to enforce user and all other nearby personnel at worksite to wear eye protection when operating the tool.
- It is recommended to wear ear protection near or at the job site to prevent hearing damage.
- Beware of the danger of entangled clothe and hair. Do not dress loose clothing and jewelry at work. Keep you hair, clothing, and gloves away from moving part of the tool.
- Keep your finger AWAY from the trigger when the tool is not in use. This will prevent accidental fire of the tool.
- This tool is not designed to be used in explosive atmosphere. The design of this tool will generate spark and the exhaust will also cause possible danger to ignite highly flammable fuel or gas. Do not use this tool in this kind of environment. Please also not smoke while using or handling the tool and fuel cell.
- The fuel cell is high pressure liquefied gas bottle. Keep it away from spark, fire or high temp and explosive environment. Do not puncture the bottle or attempt to open the fuel cell. When the fuel used up, do not incinerate the bottle. Follow the recycle instruction on the bottle.
- Do not store the tool in temperature above 120°F(50°C). High temperature will result in explosion or fire and the release of flammable gas. When not in use, keep the tool from high temperature source or direct sun light.
- The tool needs to be used in well ventilated area. Do not inhale the exhaust or fume or the gas because they are potentially dangerous to human body.
- Keep body balance when operating the tool, do not over reach.
- Keep the tool, fuel, charger and battery out of the reach of children. The tool is dangerous in the hand of untrained person.

Tool safety warning

- Do not modify or repair the tool in any method other than the original design. The tool may function unexpectedly after the modification and cause dangerous.
- Never point the nozzle of the tool to anyone includes yourself. This tool is self-contained with power source and will be dangerous if not use with care. Always assume the tool is loaded with nail and fuel.

- Do not drive this tool over materials that is too hard or too soft. Hard material can ricochet nail and hurt people, soft material may be penetrate easily and cause the nail to free fly.
- Please use only lubrication liquid specified in this manual to perform the lubrication. Use other lubrication may cause damage to the tool and the risk of malfunction that will injure the operator.
- Please keep the tool in clean condition, wipe off grease or oil after work. Do not use any solvent based cleaner to clean the tool. It is possible the solvent will deteriorate the rubber or plastic components on the tool. Greasy handle and body will cause accidental drop of the tool and injury to nearby person.
- Please use fastener specified in this manual and on the tool. Use fastener that is not compatible to the tool will cause jamming of the tool and injury to operator or nearby person.
- Do not use the tool to perform other job than designate function. Especially not use the tool as a hammer, impact on the tool will increase the risk of cracked body and accidental discharge of fastener.
- Remove the fuel cell and battery before performing maintenance, repair, cleaning and jam clearing.
- Load the fastener at last to prevent unexpected danger of loading fuel cell and battery.
- Never use the tool if the trigger and safety or springs are damaged in any way.
- When fastening electrical cables, make sure the cables are not energized.
- Hold the tool only by insulated gripping surfaces. Use only fasteners designed for electrical cable installations. Inspect that the fastener has not damaged the insulation of the electrical cables. A fastener that damages the insulation of electric cables can lead to electric shock and fire hazards.

Fuel safety warning

- Use only the fuel cell recommended by the manufacturer. Read the Safety
- Data Sheet to understand more of your fuel cell contents.
- Recycle the empty fuel cell according to the local law. Do not attempt to recharge the fuel cell or incinerate the empty fuel cell.
- Do not expose the fuel cell or tools loaded with fuel cell under direct sun light exposure. Prevent to put above items at temperature higher than 120°F(50°C). Overheating the fuel cell can result in explosion or fire.
- Do not puncture or attempt to open the fuel cell. The fuel cell contains flammable gas even if it appears empty.
- The content of the fuel cell is extremely flammable, keep it away from all source of ignition.

Battery safety warning

- Use only batteries that are supplied by the manufacturer.
- Recycle the battery according to local law. Do not incinerate the battery or attempt to puncture and crush the battery.
- Do not immerse the battery into water or other fluid. Do not expose the battery to rain or snow.
- Do not expose the battery or tools loaded with battery under direct sun light exposure. Prevent to put above items at temperature higher than 120°F(50°C). Overheating the battery can result in explosion or fire.
- Do not allow direct contact of the battery nodes with metal or conductive material.
- Charge the batteries every 3 months even the tool is not used to prevent battery over-discharged over time.

Charger safety warning

- Do not use the charger in explosive atmosphere. The electrical device is not designed to use in such environment.
- Do not charge battery outdoors or in temperatures below 40°F (5°C).
- Do not puncture or attempt to open battery case or cells.
- Do not immerse the charger into water or other fluid. Do not expose the charger under rain or snow.
- Do not use the charger if the cord is damaged or the charger is defect.
- Unplug the charger by pulling the adaptor unit, not by pulling the cord.
- Do not cover the charger with anything.
- Do not use a step up transformer or engine generator as the power source of the charger.
- Please charge the battery for at least 6 Hours before the first time use of the new battery.

2. Operation instruction

Load and unload the fuel cell

- Open the fuel cell door by pulling the door and rotate.
- Insert the fuel cell into the chamber.
- Align the fuel cell nozzle to the fuel stem on the tool.
- Close the fuel cell door.

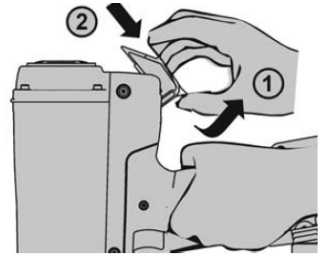

Load and unload the fastener

- Connect to battery and fuel cell before you load the fasteners. The tool had the chance to cycle once when connected to the battery. If you load the fastener before the battery connected, the fastener may be shoot out accidentally.
- Point the nozzle away from any personnel and keep your finger out of trigger when loading the fastener.
- To load the nail, slide in the nail strip into the magazine until the nail strip passed the nail stopper.
- Pull the pusher until it is beyond the stopper.
- Release the pusher to engage the nail strip and feed it into the nozzle.
- To unload the fastener from the magazine, press the release lever on the pusher and tilt the tool to slide the nail strip to the rear end of the magazine.
- Unload the nail strip by press the nail stopper and slide out the nail strip.
- For 3 steps magazine design, follow the same safety precaution and continue with following steps
- To load nail, pull the pusher to the rear until it is locked to the magazine at rear position.
- Slide nail strip into the magazine.
- Release the pusher to push the nail into the nozzle.
- To unload the fastener from the tool, pull the pusher to the rear locking position. Slide the nail out of the magazine.

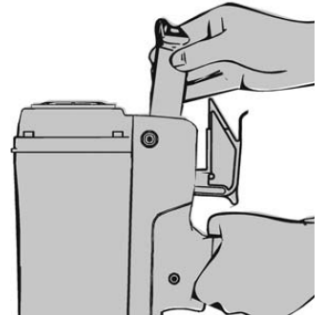

Depth of drive adjustment

- This tool is equipped with tool free depth of drive adjustment. Test the depth of drive on scrap piece before you start your work.
- Turn the knob to adjust the depth of drive.
- Repeat above procedure until you find your desired depth of drive setting.

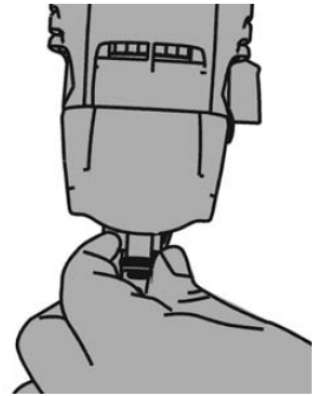

Actuate method and the steps to fire the tool

- This tool is equipped with single sequential trigger system only.
- To actuate the tool, depress the safety against the work piece, and then pull the trigger.
- To actuate the tool again, you will need to release the safety fully and release the trigger before you repeat above procedure.
- Make sure you are driving against work piece before you pull the trigger.

Jam clearing for tool

- In the case of nail jam, disconnect the power source (fuel cell and battery) before you perform any action.
If your tool is equipped with jam clear door, open the quick jam clear door on the side to expose the jammed nail.
If your tool is equipped with removable nozzle, press the release button and pull off the nozzle.
- Remove the jammed nail with needle nose pliers or similar type of tool. Do not use your hand to remove the nail.
- Close the jam clear door or assemble back the nozzle after you clear the jam.

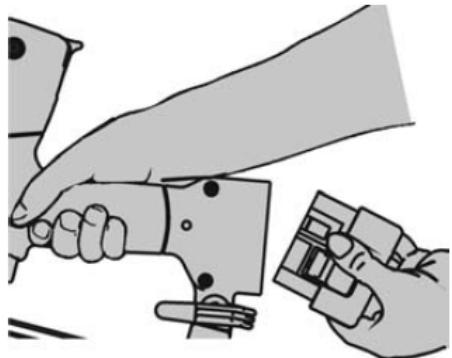

Charge the battery and LED on tool and charger

- There is battery comes along with the tool. It will take 2 hours before the new battery can be fully charged.
- There will be no LED light when the charger is connected to electric and no battery is on the charger.
- The LED on the charger will turn red when it is charging a battery.
- The other LED will turn green when the battery is fully charged.

In the case of battery failure, the red and green LED will blink in sequence.

- When the tool is connected to a charged battery, the LED indicator on the tool will turn green.

If the tool is running out of battery, the indicator LED will turn red. When the LED indicator turns red, stop using the tool and replace the battery.

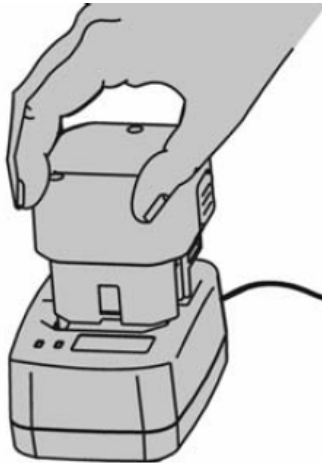

3. Maintenance instruction

Warning: disconnect the power source (fuel cell and battery) before performing any maintenance

General maintenance

- Keep the tool in clean condition at all times. Wipe off grease or oil with dry clean cloth to prevent accidental tool drop. Avoid to use solvent base cleaner to clean the tool, certain solvent will damage or weaken the composite parts of the tool.
- Clean the intake filter regularly to keep the tool in full efficiency.

Lubrication and cleaning

- This tool should not need extra lubrication since the fuel already contains some lubrication oil.
- The combustion chamber and cylinder can be cleaned by applying automobile carburetor cleaner. You will need to remove the 2 screw on the handle and 4 screws on the top cap to expose the internal component of cylinder.

Cold weather

- This tool is not suggested to be used in cold winter. The cold weather will decrease the combustion efficiency and also the battery performance. Use the tool only at temperature above : -7°C (19°F).

4. Trouble shooting

symptom	Counter measures
Red LED indicator light is on and the tool did not operate.	<ul style="list-style-type: none"> • Battery charge might be too low. • Replace battery with a fully charged one.
Tool operates normally but did not drive the nails to flush.	<ul style="list-style-type: none"> • If the number of remaining nails is 3, insert another strip. • Adjust the depth of drive setting to dee pest. • Clean the cylinder with proper cleaner. • Check fuel cell and replace as required. • Depress the safety and hold for 1 minute before activate the trigger. If the tool did not fire, there might be seal leaking over the combustion chamber. Send to service center near you.
Fan does not run and the indicator light is red.	<ul style="list-style-type: none"> • The battery is out. Replace the battery with a fully charged one. • The battery node is dirty or oily. Clean the battery node with clean cloth. • If all above did not work, send to service center near you.
Battery does not accept charge or the charger get hot when charging.	<ul style="list-style-type: none"> • Replace the battery. If this action corrects the problem, the battery is damaged or exhausted. • Replace the charger if the battery works fine on tool but can not be charged on charger..
Charger get hot, make noise or start to smoke	<ul style="list-style-type: none"> • The charger is damaged and should not be used any more. Unplug the charger immediately and replace it with a new charger.
Work contact element is not fully depressed and the tool can not be used.	<ul style="list-style-type: none"> • The work contact element is bend or the track of the safety mechanism is sticky to the dirt build up. Clean the safety track. Repair or replace the work contact element. • Lock out mechanism is active. Load more nails.

symptom	Counter measures
Tool will not cycle, the indicator LED is green and the fan runs.	<ul style="list-style-type: none"> • Run out of fuel, replace a new fuel cell. • Spark wire is loose, check the spark wire by removing the cap. • Spark plug is dirty. Clean the spark plug. • If all above did not work, send to service center near you.
Tool operate normally, but no nail is driven	<ul style="list-style-type: none"> • Wrong type of nails was used. Please change to correct nail spec. • The cylinder needs cleaning. • Nail is jammed, clean the jammed nail before use. • The nail pusher did not engage properly with the nail strip. Adjust to fully engagement.
Combustion chamber is not returning to start position.	<ul style="list-style-type: none"> • The work contact element is bending or dirty. <p>Check the work contact element and repair or replace it. Clean the safety track.</p>
Driver did not return to initial position, miss fire frequency get higher than usual.	<ul style="list-style-type: none"> • Check and replace fuel cell. • Clean the tool with proper cleaning fluid. • Check for piston ring wear status. • The tool maybe over heated. Clean or replace the intake air filter.
Tool appears to be loosing power.	<ul style="list-style-type: none"> • Check fuel cell. • Clean or replace air intake filter. • Check spark plug wire. • Clean the tool with proper cleaning fluid.
For failure other than above situation, please stop using the tool and contact your local dealer for service.	

5. Declaration of conformity

Gas Concrete Nailer

1. Fastener type and size
 - Nail shank : 2.6~3.0mm(0.102"~0.118")
 - Nail length : 15~40 mm(9/16"~1-1/2")
 - Collation type : plastic collation
 - Nail strip angle : 0°
 - Magazine capacity : 4 nail strips, or 40 nails
2. Tool spec
 - Model number : BOSSG40
 - Type of tool : Concrete Pin Nailer
 - Dimension(LxWxH) : 460 x 116 x 375mm
 - Weight of tool : 3.8 Kg(8.4lb)
 - Shot limit : 1000 shots/hour
 - Drive rate : 2-3shots/sec
 - Charge time of battery : 120mins
 - Battery voltage : 6 Volt
 - Shots per Charge : 4500shots
 - Shots per fuel : 1200shots
 - Usable temperature : -7°C(19°F)~50°C(120°F)
 - Applications & suitability : Dry wall track, steel to concrete job
 - Actuating system (safety yoke installed) : full sequential only
 - Trigger device : Finger activated trigger.
3. Noise and vibration data
 - Noise characteristic values in accordance with EN 12549+A1
 - A-weighted sound pressure level at workstation : 97.4 dB
 - A-weighted sound power level : 100.8 dB
 - Peak C-weighted instantaneous sound pressure level at workstation: < 130dB
 - Vibration value according to ISO 8662-11+A1 : 3.67 m/s2
 - Measurement uncertainty (Standard) : 1.83 m/s2

Declaration of conformity

We

BOSSONG S.p.A.

Via Enrico Fermi, 51 (Z.I. 2)

24050 GRASSOBBIO (Bergamo) Italy

Tel. +39 035 3846 011

declare under our sole responsibility that the conforms with the directive and the standards

Chiodatrice a gas per calcestruzzo BOSS G40

2006/42/EC (MSD);2006/95/EC (LVD);2004/108/EC (EMC)

2011/65/EU (RoHS)

EN ISO 12100;EN 792-13+A1;EN 12549+A1;ISO 8662-11+A1

EN 60745-1;EN 60745-2-16;EN 55014-1;EN 55014-2+ A2

EN 61000-3-2;EN 61000-3-3;EN 50581

EN 60335-1;EN 60335-2-29;EN 62233

EN 61558-1;EN 61558-2-16

Serial number

signed:



Andrea Taddei – Direttore Generale